

Upstand
(Drg.No: D0901-00W_1-2Deg_201-Ext-XF301-SM_001)

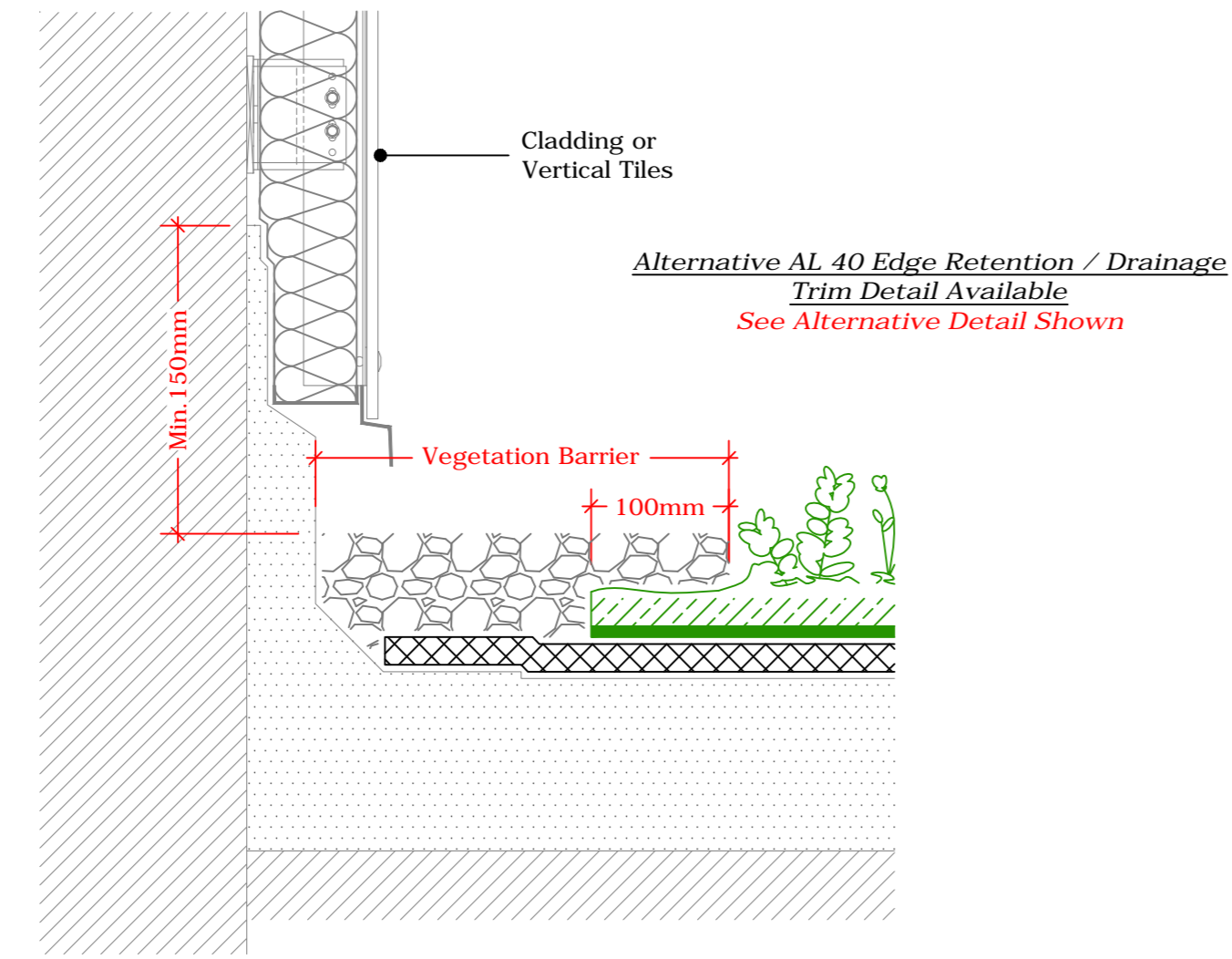

Upstand to Vertical Cladding or Slates/Tiles
(Drg.No: D0901-00W_1-2Deg_201-Ext-XF301-SM_002)

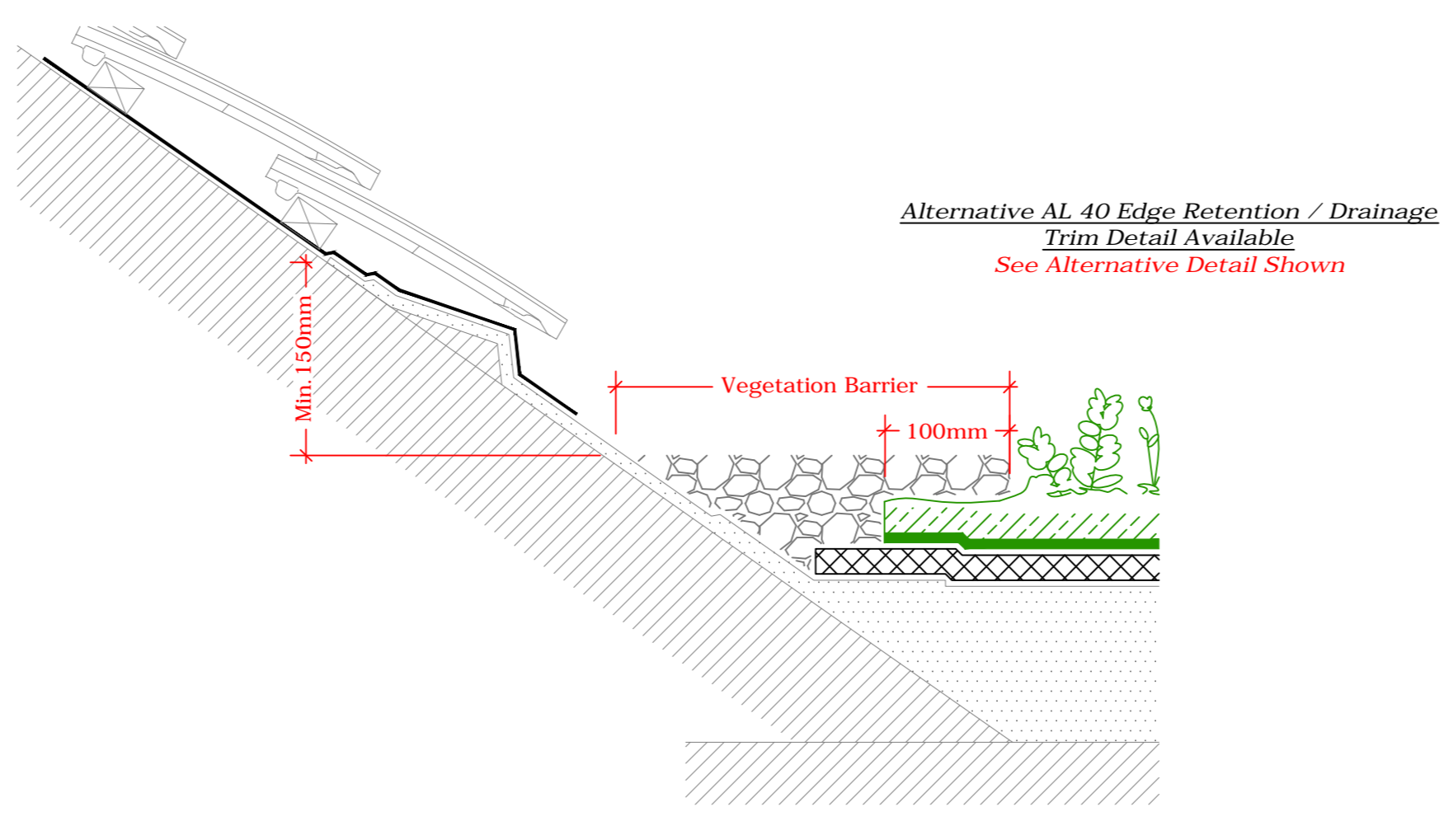

Upstand to Pitched Roof
(Drg.No: D0901-00W_1-2Deg_001-Ext-XF301-SM_004)

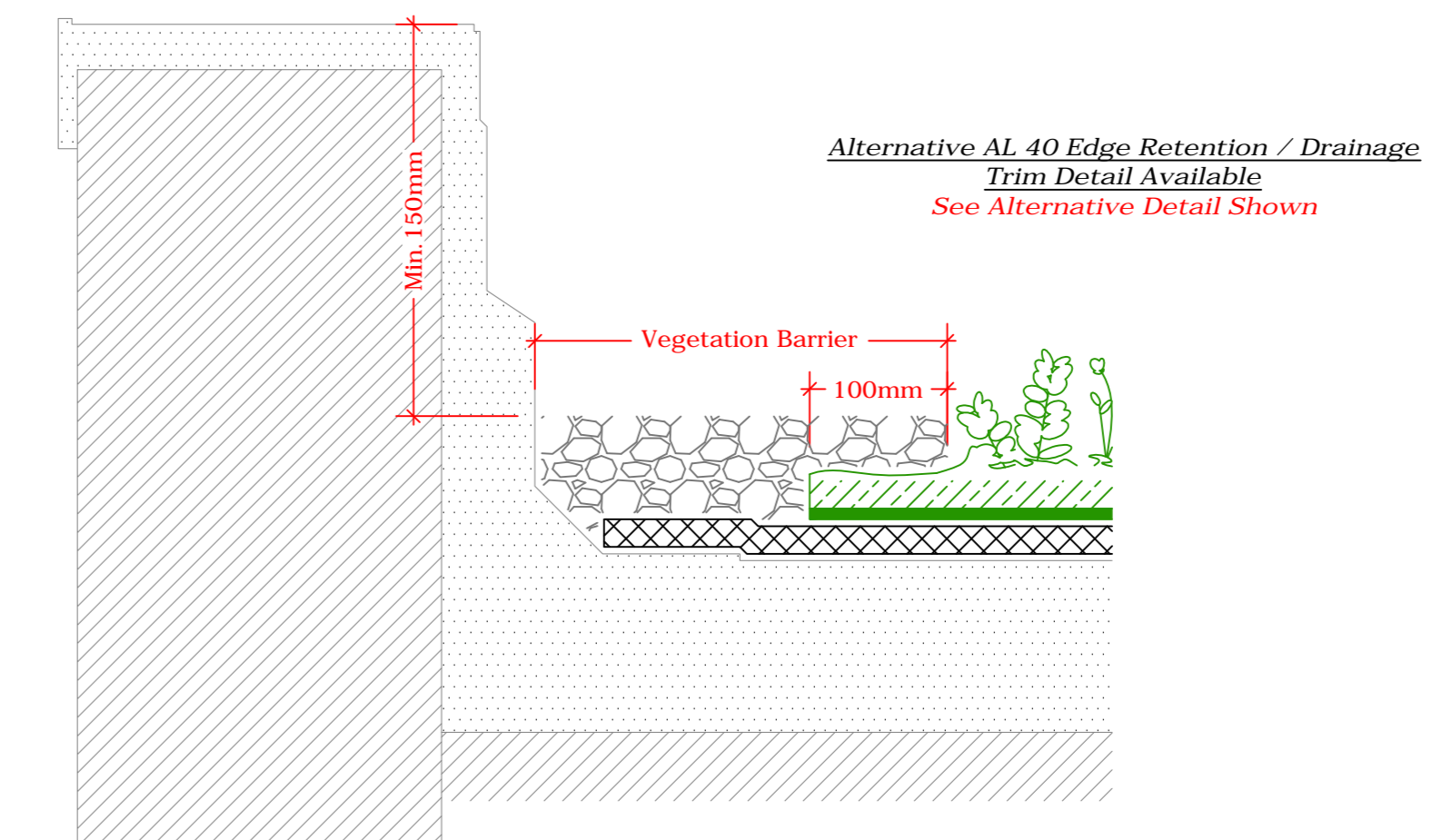

Parapet Upstand
(Drg.No: D0901-00W_1-2Deg_203-Ext-XF301-SM_001)

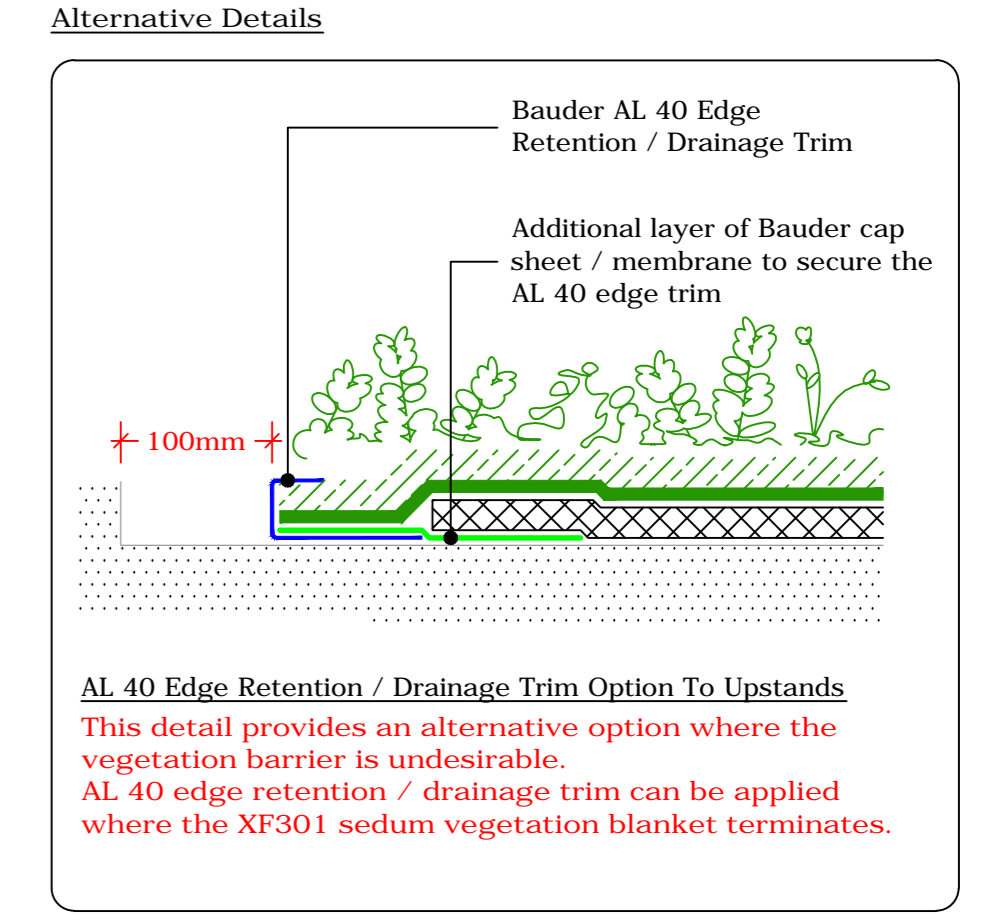

Alternative Details
AL 40 Edge Retention / Drainage Trim Option To Upstands
This detail provides an alternative option where the vegetation barrier is undrivable. AL 40 edge retention / drainage trim can be applied where the XF301 sedum vegetation blanket terminates.

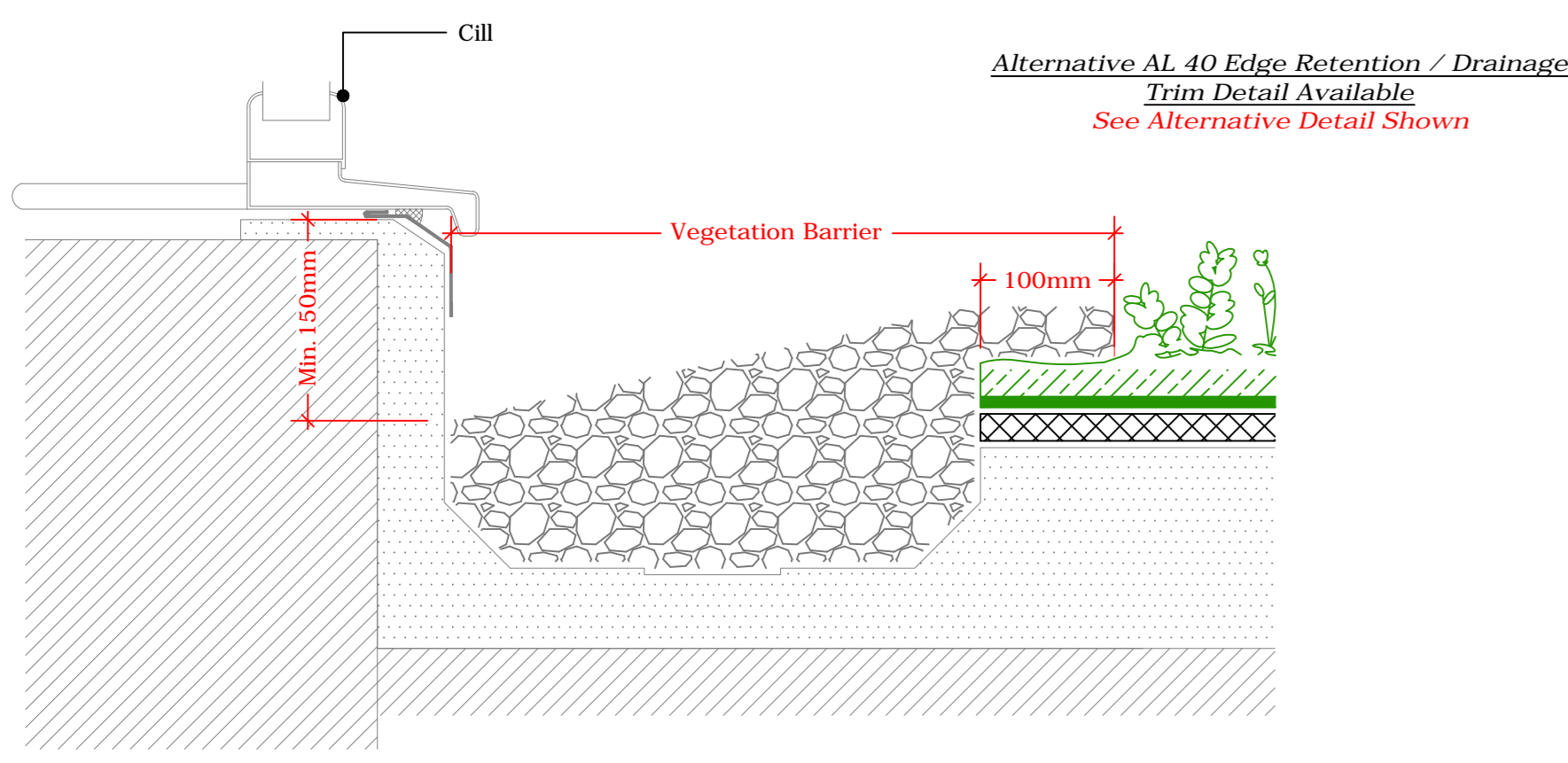

Internal Gutter to Clerestory Window
(Drg.No: D0901-00W_1-2Deg_206-Ext-XF301-SM_003)

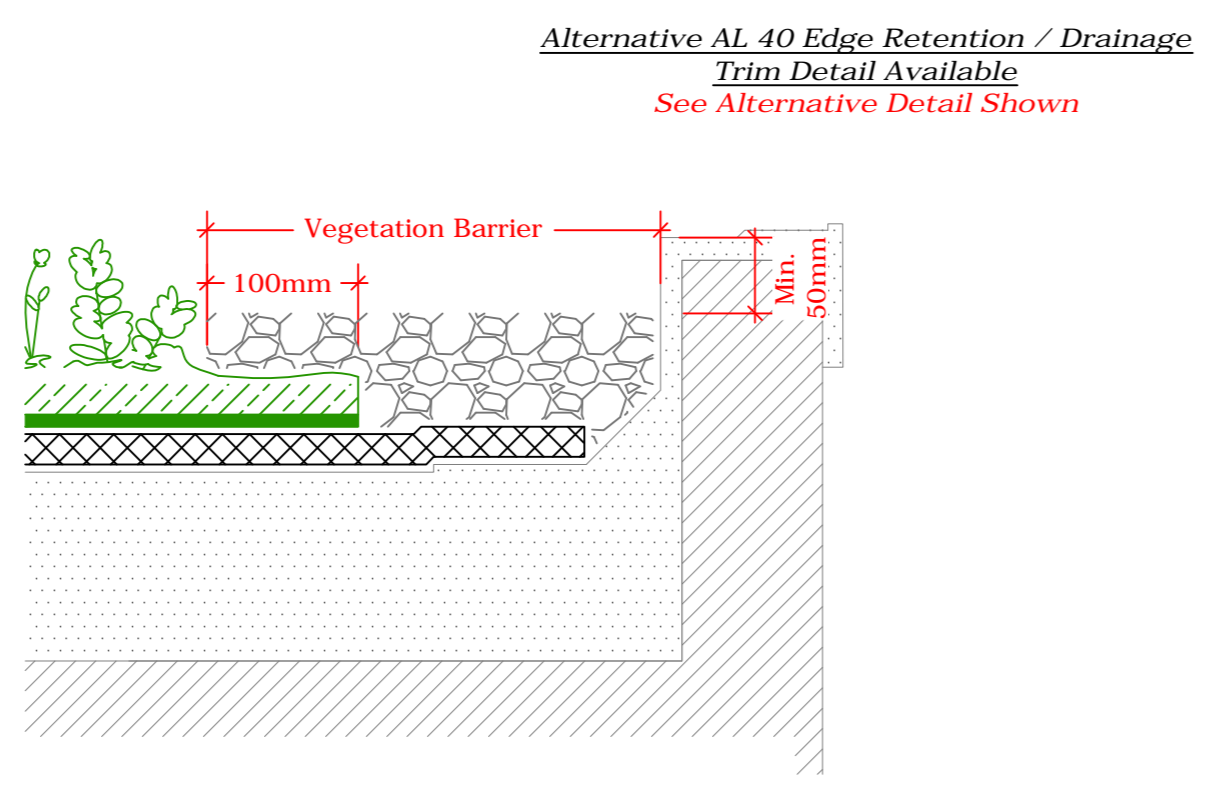

Perimeter Kerb
(Drg.No: D0901-00W_1-2Deg_002-Ext-XF301-SM_001)

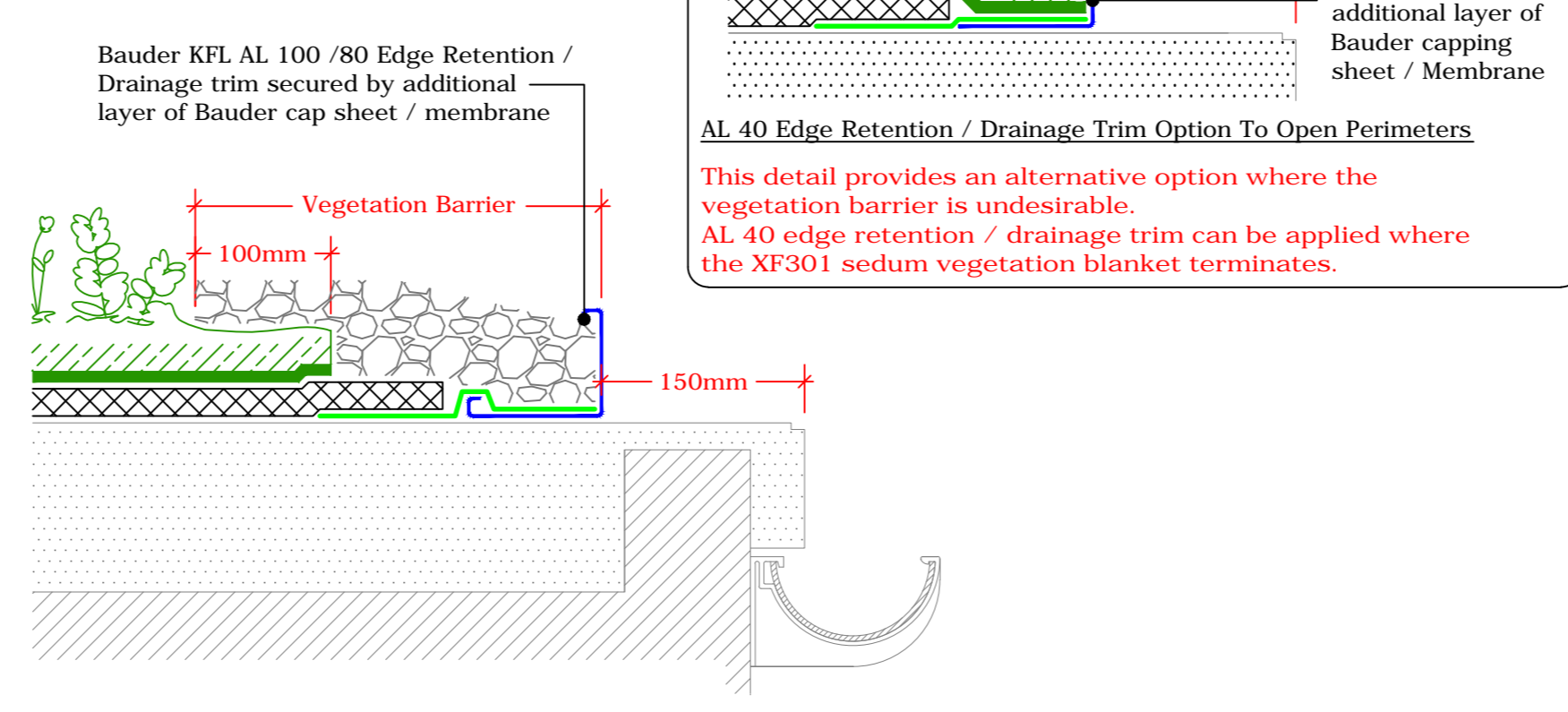

External Gutter
(Drg.No: D0901-00W_1-2Deg_006-Ext-XF301-SM_005)

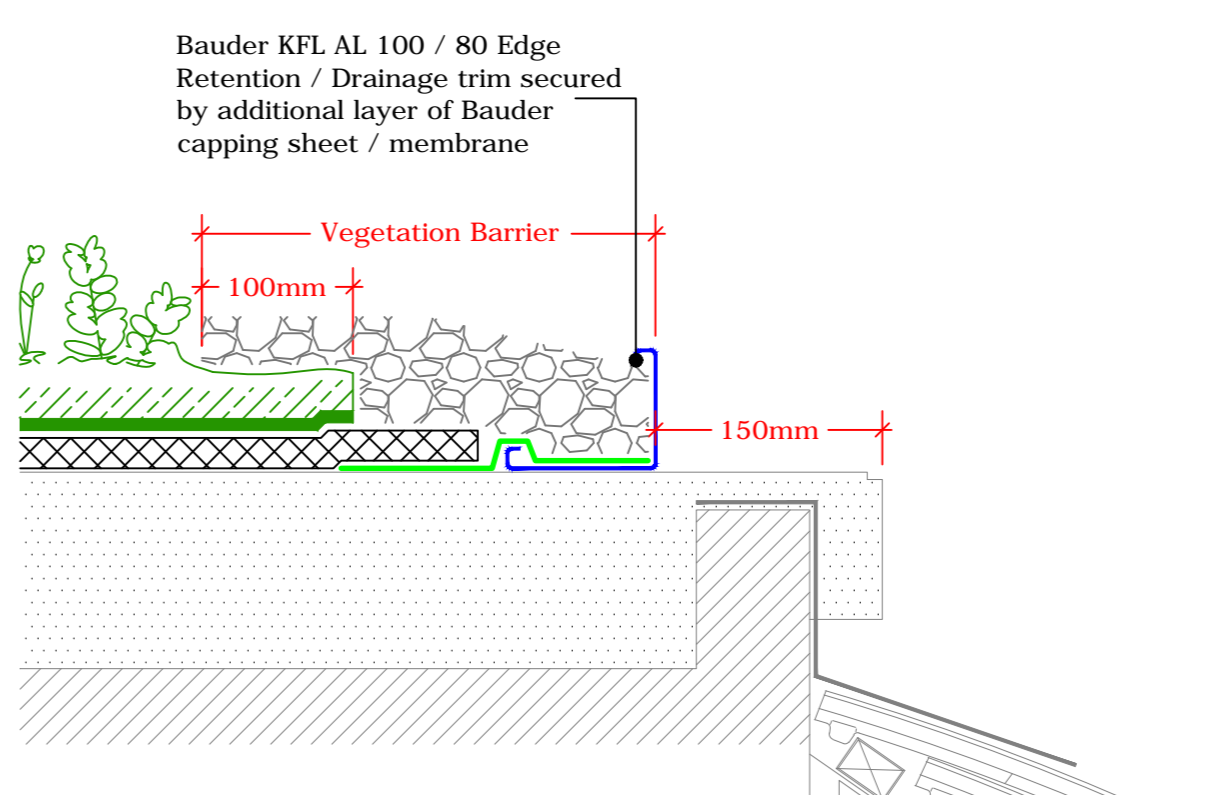

Detail to Mansard Roof
(Drg.No: D0901-00W_1-2Deg_006-Ext-XF301-SM_006)

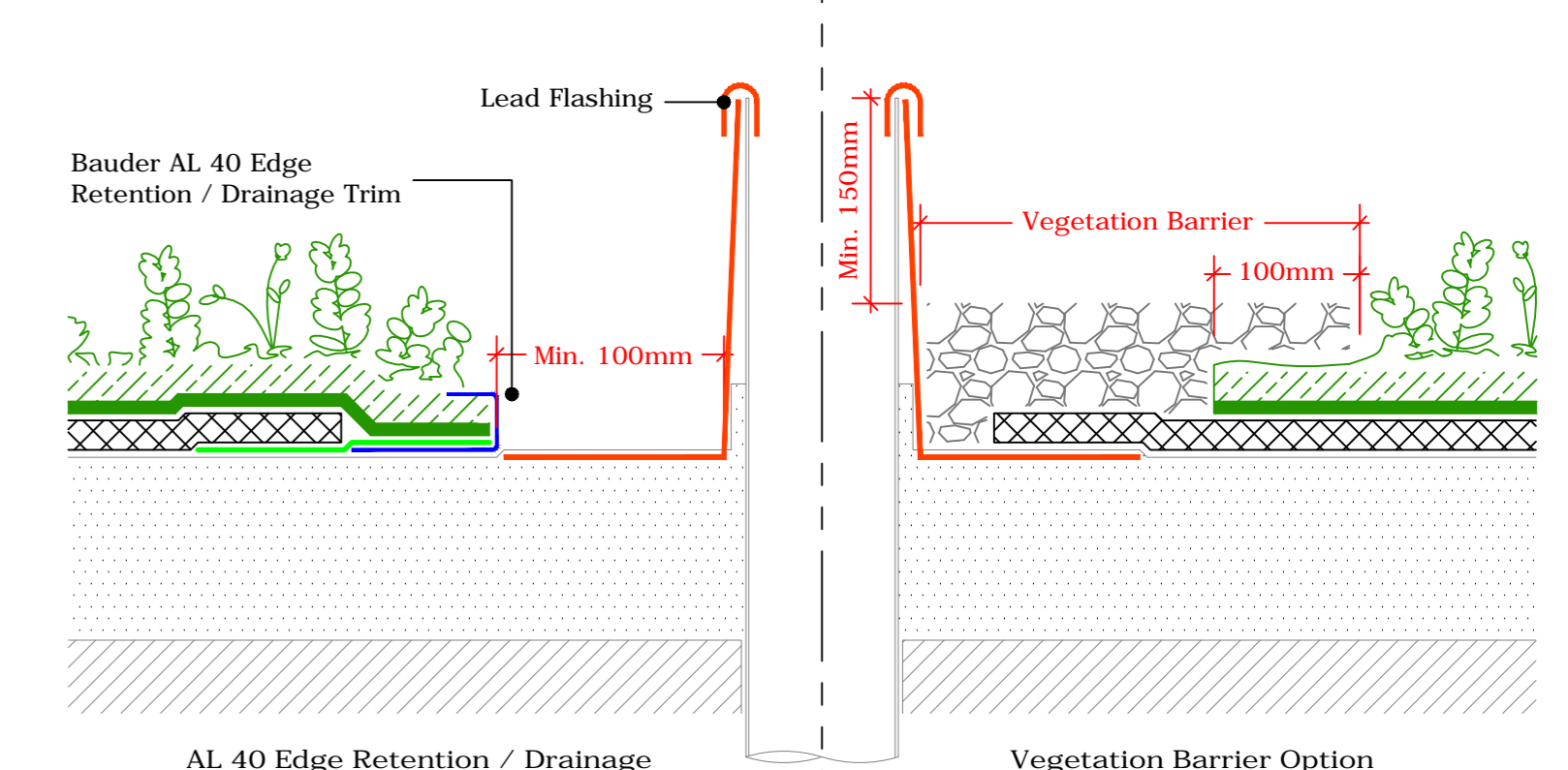

Upstand - Soil Vent Pipe
(Drg.No: D0901-00W_1-2Deg_007-Ext-XF301-SM_001)

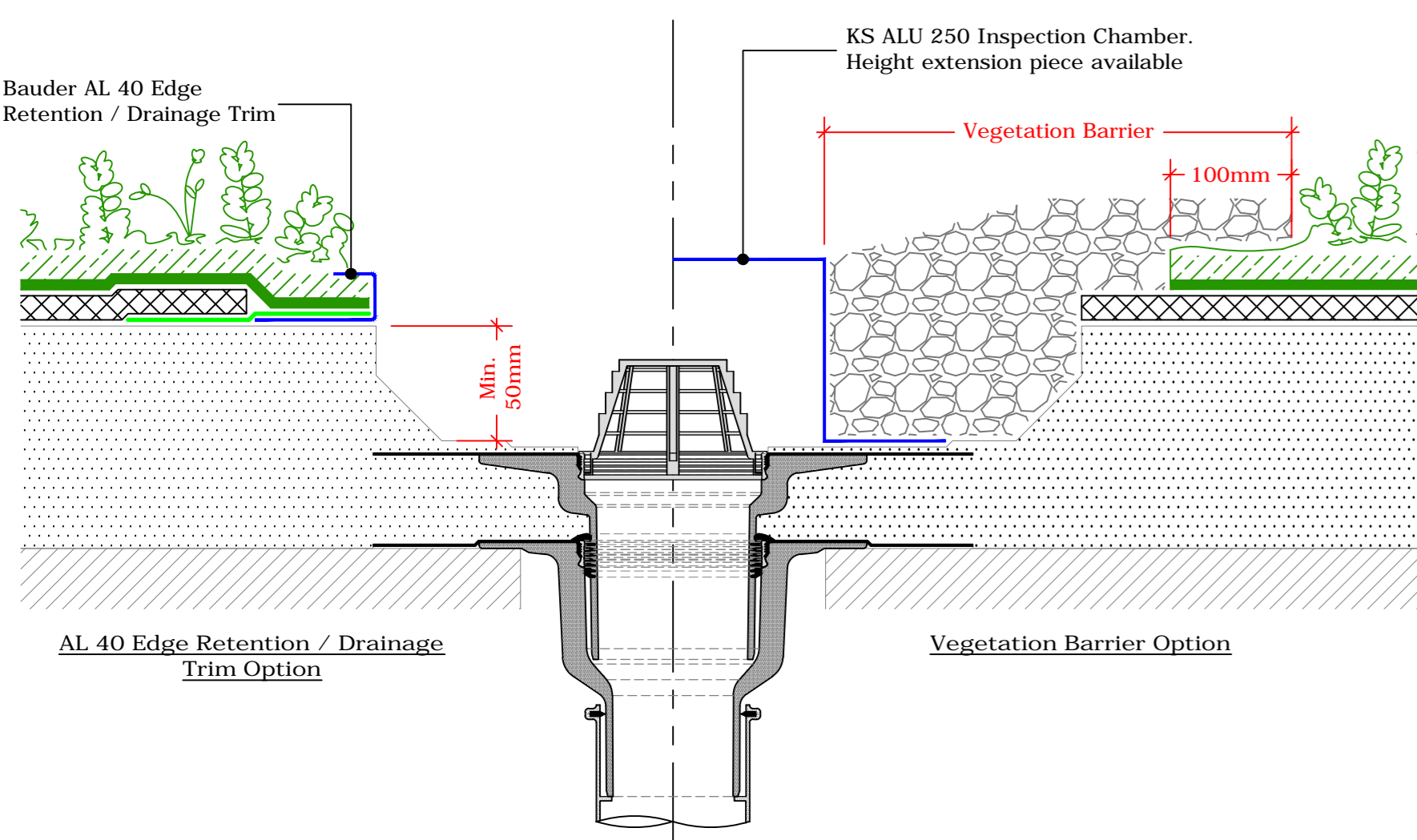

Bauder Outlet - Compact
(Drg.No: D0901-00W_1-2Deg_008-Ext-XF301-SM_001)

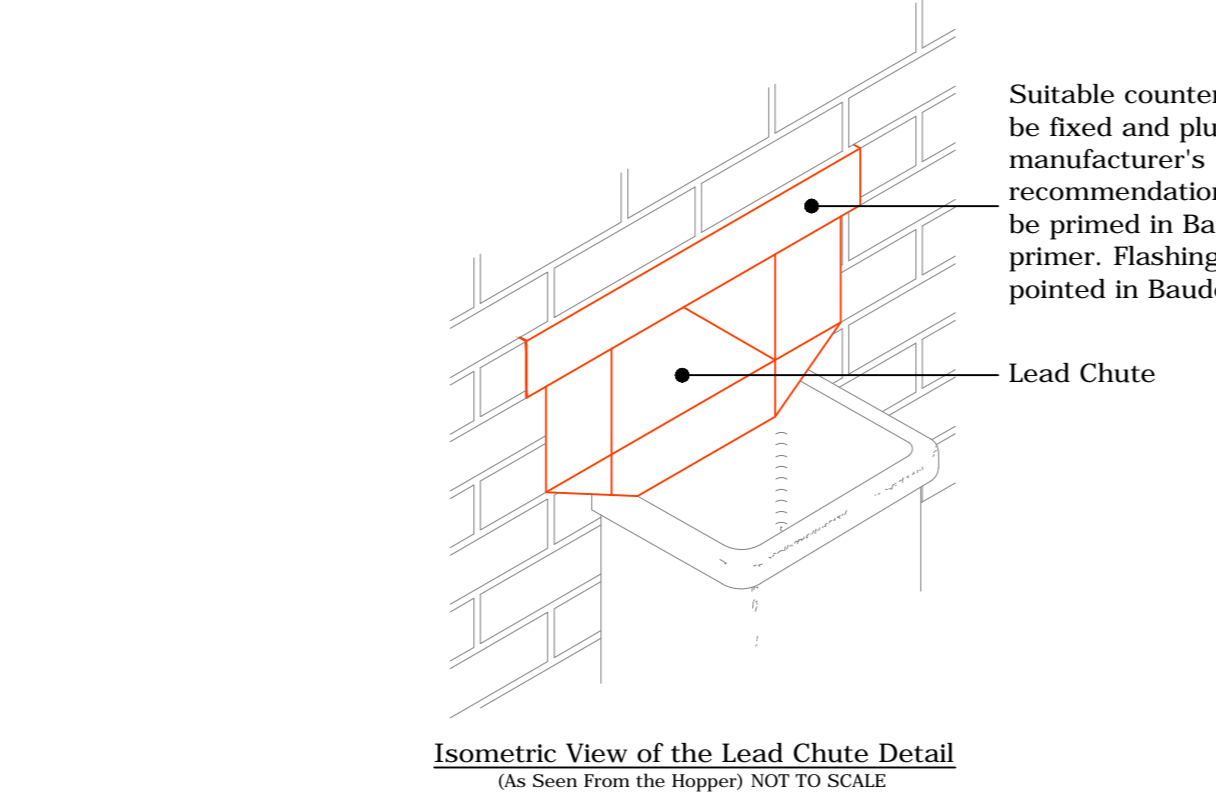

Isometric View of the Lead Chute Detail
(As Seen from the Support NOT TO SCALE)

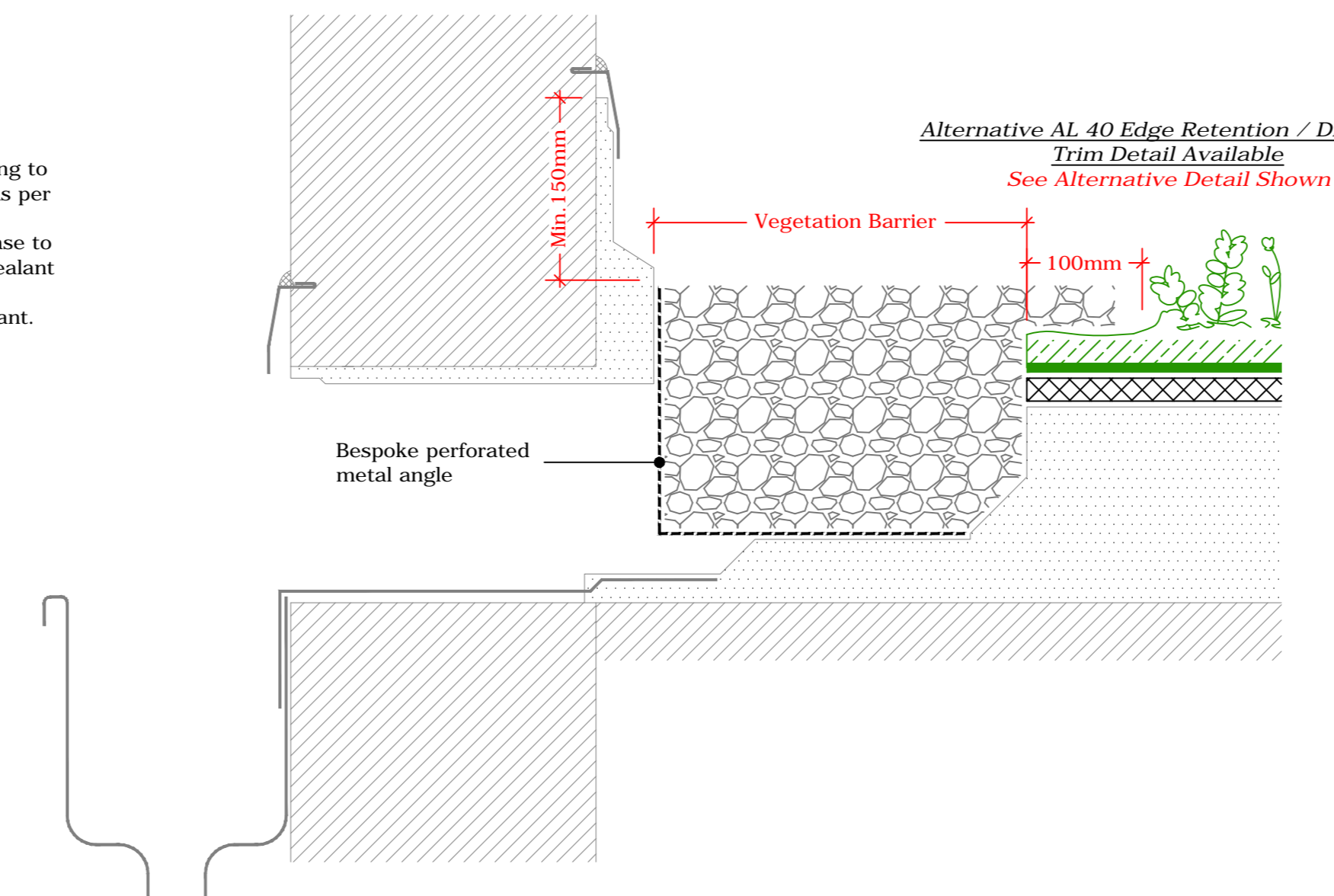

Upstand - Lead Chute
(Drg.No: D0901-00W_1-2Deg_206-Ext-XF301-SM_002)

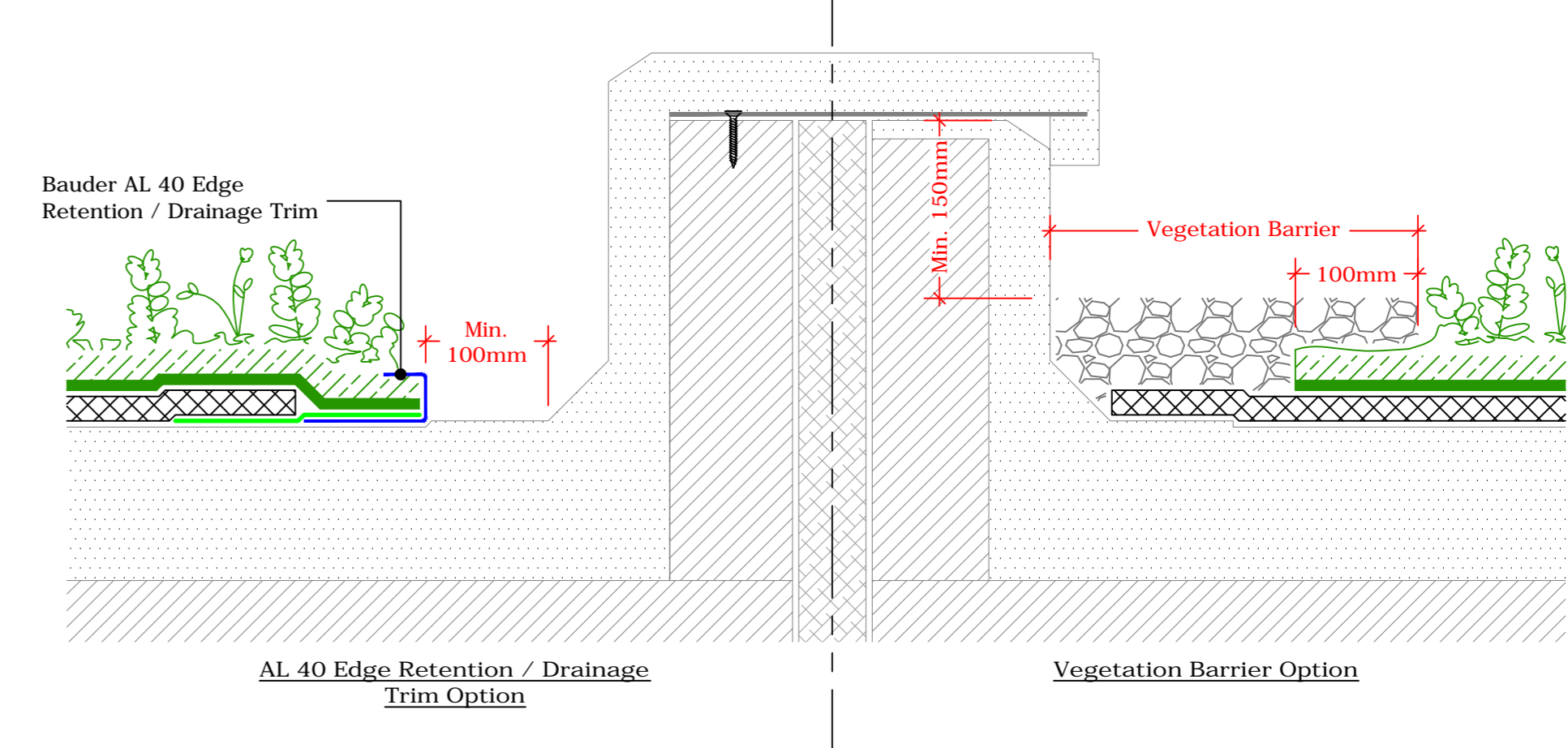

Twin Kerb Expansion Joint
(Drg.No: D0901-00W_1-2Deg_204-Ext-XF301-SM_001)

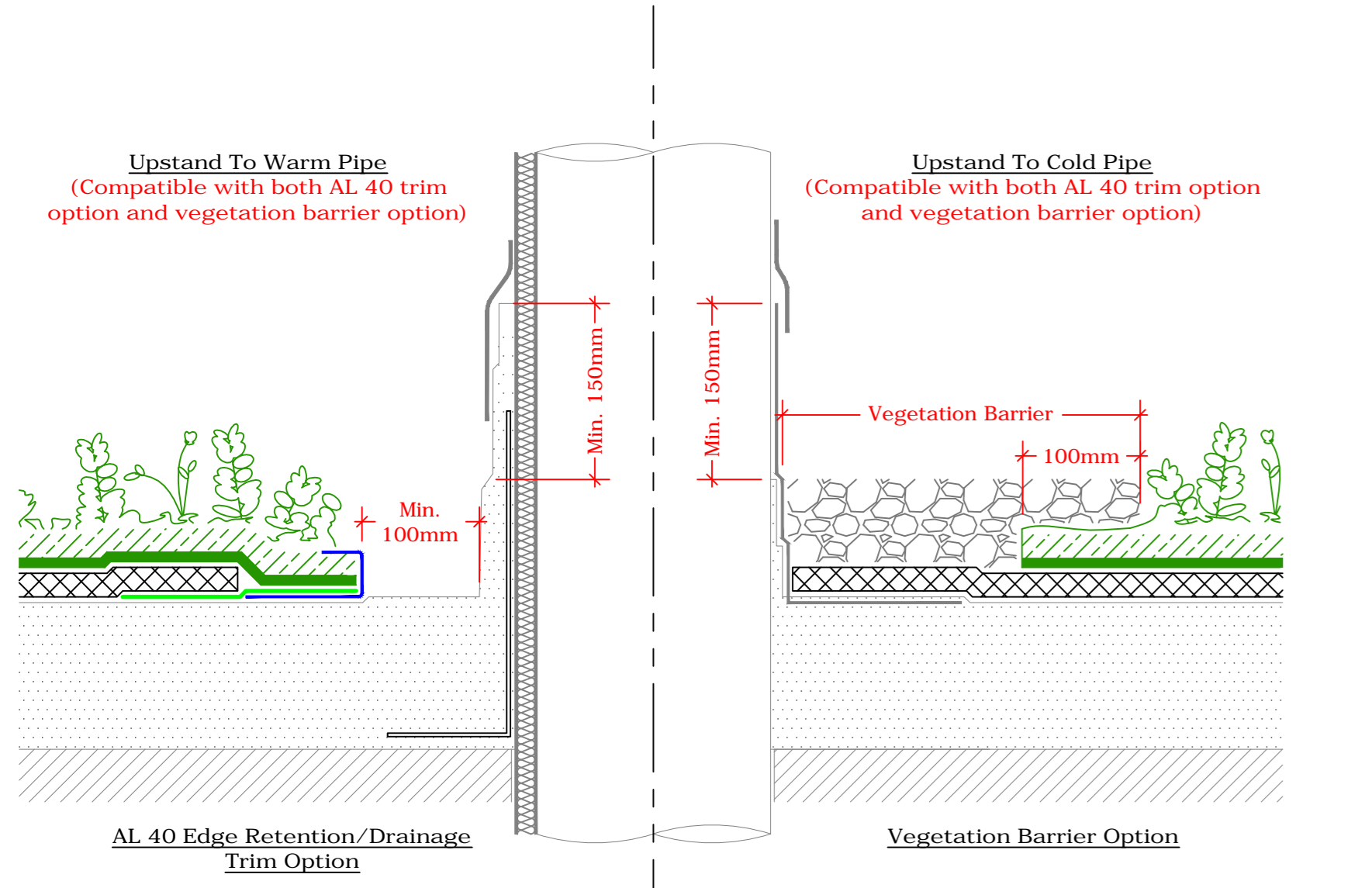

Upstand to Hot Flue Or Cold Pipe
(Drg.No: D0901-00W_1-2Deg_007-Ext-XF301-SM_002)

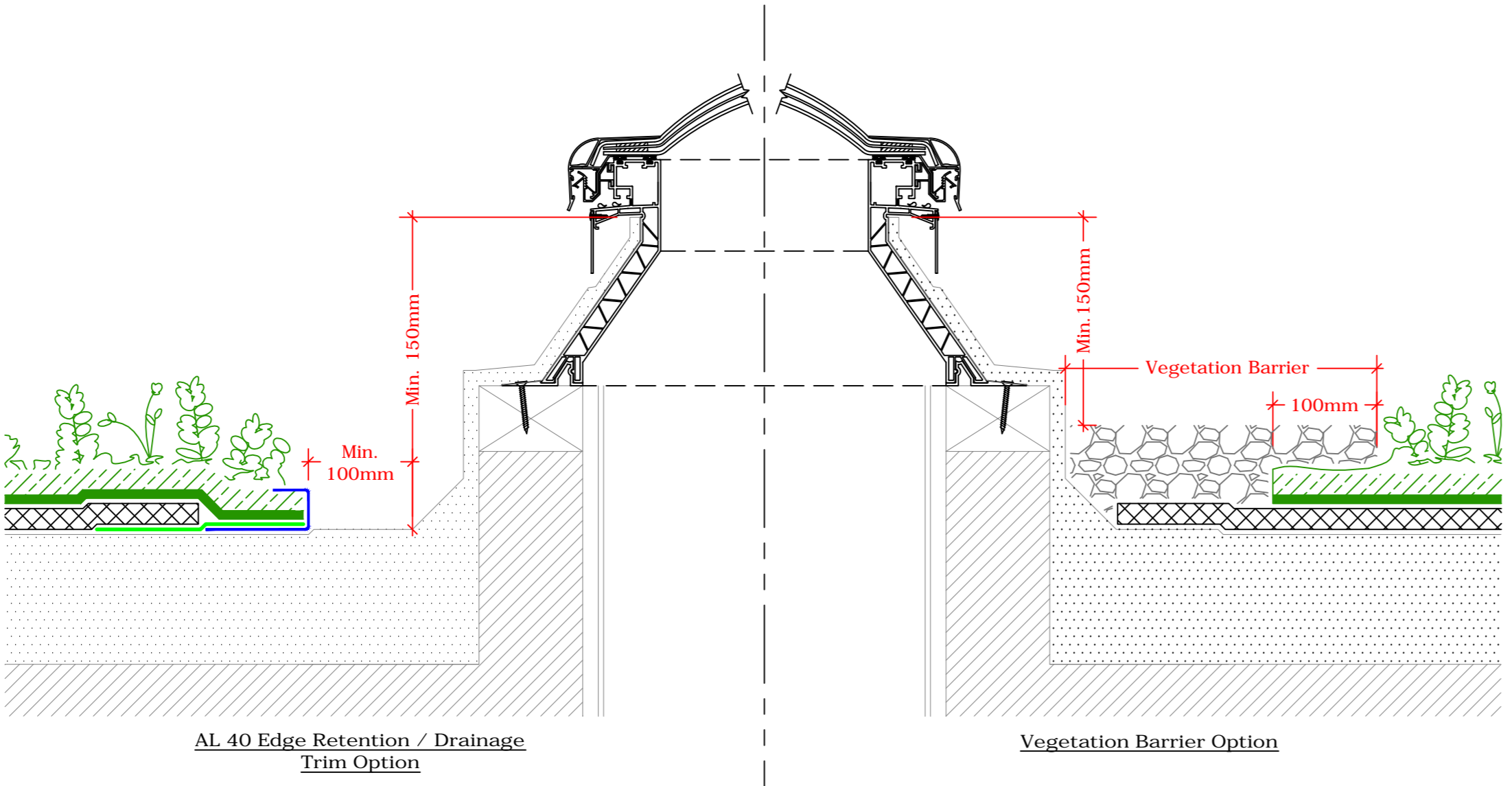

Upstand to Bauder Rooflight - Euroglaze
(Drg.No: D0901-00W_1-2Deg_008-Ext-XF301-SM_001)

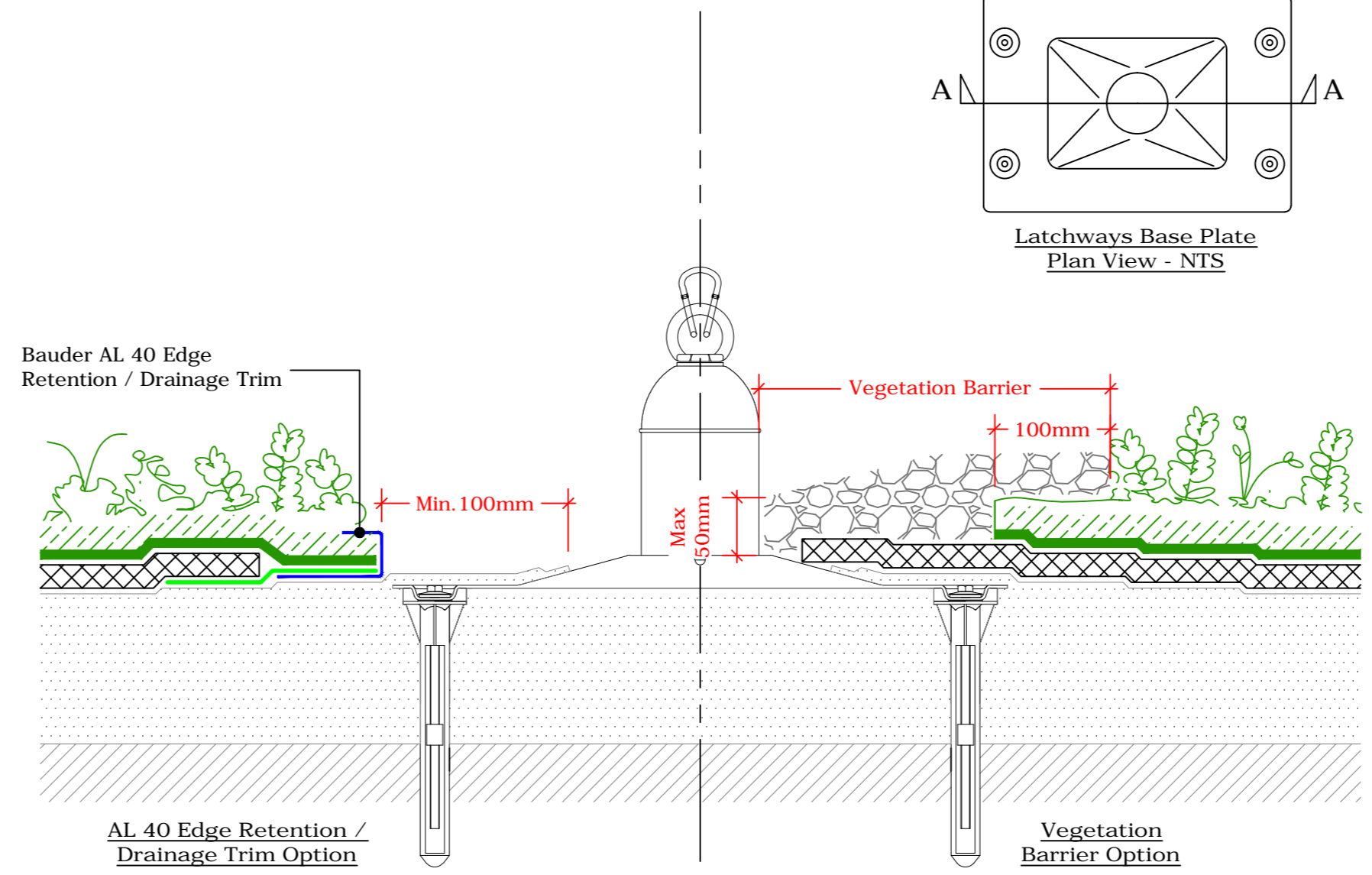

Latchways Constant Force Post
(Drg.No: D0901-00W_1-2Deg_009-Ext-XF301-SM_001)

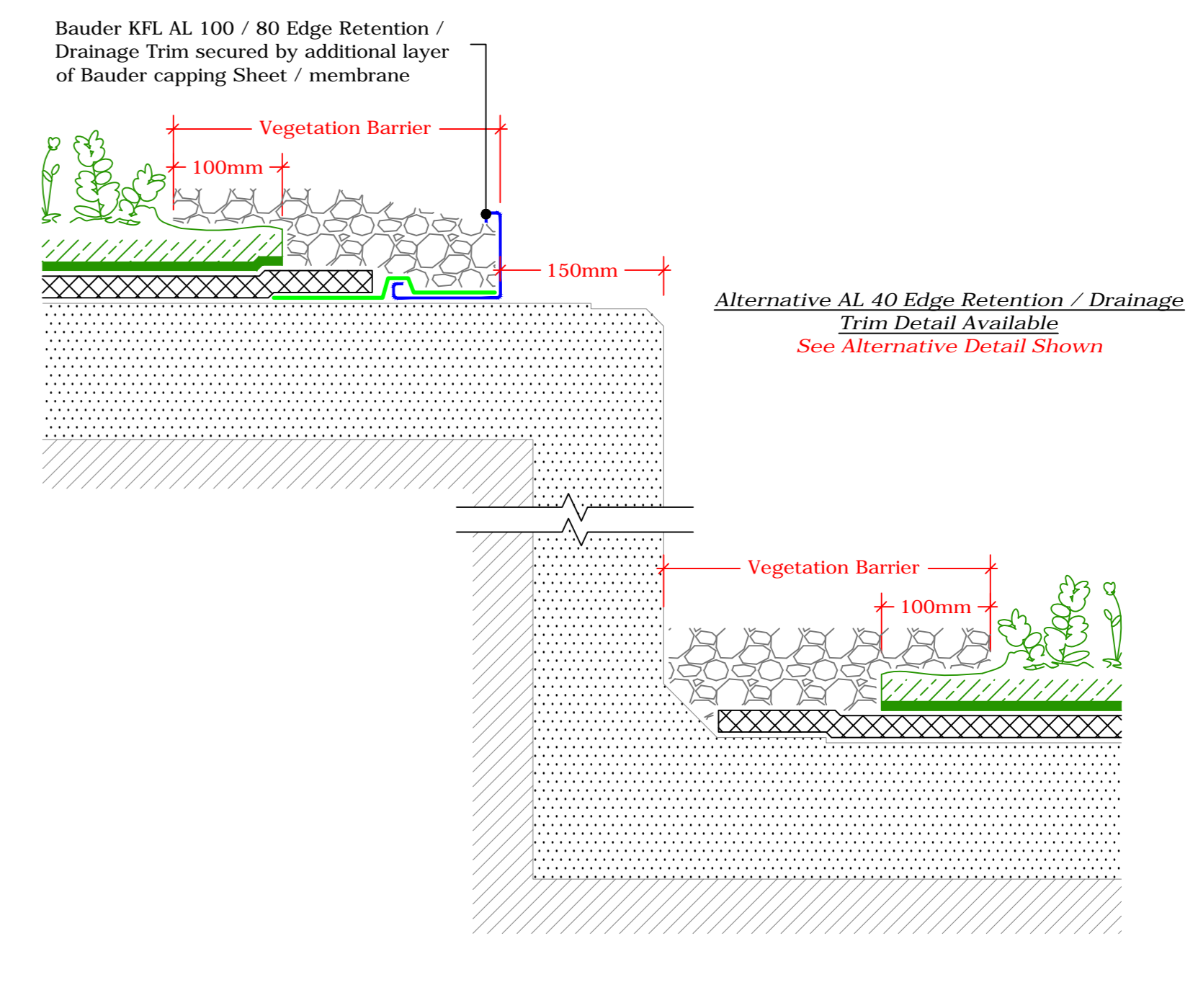

Change In Level
(Drg.No: D0901-00W_1-2Deg_210-Ext-XF301-SM_001)

Key

- AL 40 Edge Retention / Drainage Trim
- Vegetation Barrier
- Additional Bauder Capping Sheet / Membrane To Secure The Metal Trim (Refer To Specification For Correct Option)
- Bauder Waterproofing System (Refer To Specific Manufacturer's Recommendations For The Correct Solution To Be Used. Refer To The Project Specific Specification)
- Deck / Substrate
- Vegetation barrier (Minimum Release Depth & 300mm Wide. Width Must Be Increased To At Least 500mm When Positioned Adjacent To Opening, Roughing, Windows Or Door Openings. In Accordance With Both Green Green And F1 Roof Codes)
- Bauder AL 40 Edge Retention / Drainage Trim

IMPORTANT NOTE:
This Drawing Shows Alternative Details. For The Correct Solution To Be Used Refer To The Project Specific Specification.

IMPORTANT NOTES:
1. These details are suitable for use on the following Bauder Systems:
Bauder Total Green Roof System, BauderFlex Green Thermoflex and Thermoflex.
2. The Drawing Shows Alternative Options. For The Correct Solution To Be Used, Refer To The Project Specific Specification.
3. Do not scale to ascertain dimensions.
4. All dimensions to be checked and verified on site prior to commencement of work.
5. This drawing is to be read in conjunction with the specification and associated drawings.
6. This detail is a guideline only, representing typical detailing conditions and illustrates the correct application of the above Bauder Systems. It may be necessary to modify this detail to suit specific project design constraints and conditions.
7. Refer to the Bauder Specification for the product description and method of application. For clarity the method of attachment has not been shown.
8. Provision should be made by the installer for mechanically fixing the top leading edge of all spread details in excess of 200mm in height using appropriate fasteners.

BAUDER

UK OFFICE
Bauder Limited
70 Ladbroke Road, Ipswich,
Suffolk IP1 0QR,
England
Tel: +44 (0)1473 237671
Fax: +44 (0)1473 230761
Email: technical@bauder.co.uk
bauder.co.uk

IRELAND OFFICE
Bauder Limited
O'Duffy Centre, Cross Lane,
Carrigrohane, Co. Wexingham,
Ireland
Tel: +353 (0)42 8662 333
Fax: +353 (0)42 8662 870
Email: technical@bauder.ie
bauder.ie

XF301 Sedum Blanket 1°-2° Slope

D0901-00W_1-2Deg_200-Ext-XF301-SM_001

CD DW

© Copyright. This drawing is subject to copyright. No part of this document may be reproduced in any form, without the permission of BAUDER LTD.