

## BauderPVC VBL 14 pre-fabricated metal

V3 13.05.2024

### Product description

Pre-fabricated metal is an integral part of most single ply applications. Bauder single ply coated metal is 1.4mm thick, a 0.6mm thick, hot-dip galvanized steel plate, laminated on one side with 0.8mm thick layer of polymeric coating, for use in creating flashings and detailing.

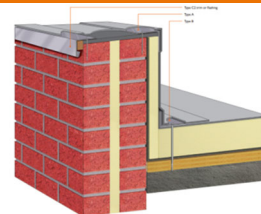

### Application fields

Bauder pre-fabricated flashings should be fastened to the structure in accordance with the detail design drawing issued for the application. A general guidance of 250mm between fasteners should not be exceeded.

For information please contact Bauder Technical Department.

### Article Numbers

GB1510110	Type A	Light Grey
GB15101120	Type A	Blue Grey
GB15101130	Type A	Anthracite
GB15102110	Type B	Light Grey
GB15102120	Type B	Blue Grey
GB15102130	Type B	Anthracite
GB15103110	Type C1	Light Grey
GB15103120	Type C1	Blue Grey
GB15103130	Type C1	Anthracite
GB15104110	Type C2	Light Grey
GB15104120	Type C2	Blue Grey
GB15104130	Type C2	Anthracite
GB15105110	Type C3	Light Grey
GB15105120	Type C3	Blue Grey
GB15105130	Type C3	Anthracite
GB15105510	Chase CT	Blue Grey
GB15106110	Type D	Light Grey
GB15106120	Type D	Blue Grey
GB15106130	Type D	Anthracite
GB15107110	Type E	Light Grey
GB15107120	Type E	Blue Grey
GB15107130	Type E	Anthracite
GB15108110	Type F	Light Grey
GB15108120	Type F	Blue Grey
GB15108130	Type F	Anthracite

Characteristic	Unit	Value
Trim length	mm	2000
Thickness	mm	1.4
Weight	kg/m <sup>2</sup>	5
Underside colour		mid grey



Light Grey  
7035



Blue Grey  
7031



Anthracite  
7016

# Technical data sheet

BauderPVC VBL 14 pre-fabricated metal is available in 3 grey colours to match the colour of the membrane in the field sheet.

Any drilling or cutting of the prefabricated flashing can be undertaken using traditional tools. Cutting is recommended using snips or metal shears as these do not leave metal filings on the roof surface.

Each flashing type is supplied in a standard 2m length. The product is dispatched in heavy duty plastic wrapping, labelled with the product details. Fasteners for securing the flashing should have a low-profile head type to reduce the visible appearance of the fastener in the finished application. Each section of pre-fabricated flashing should be positioned to ensure a 2-3mm expansion gap is left before the next section of flashing is installed. The membrane cover strap over the joint between two flashings should be un-welded for 50mm running centrally over the joint.

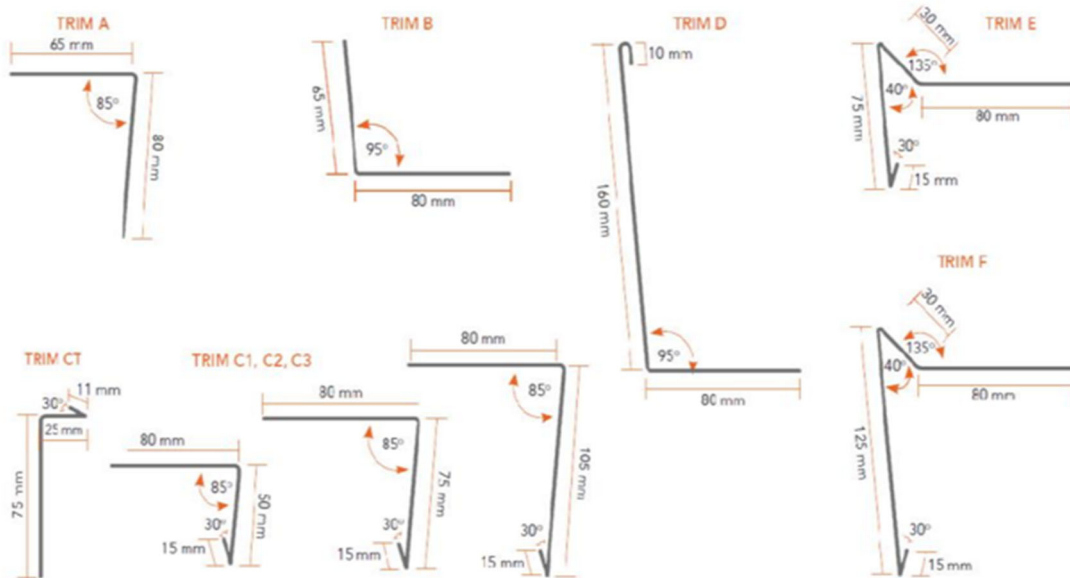

Trim Type	All Flashings 2m Long	Weight Per Pack/Kg	Qty Per Pack	Lm Per Pack
A	65mm X 80mm External 85° Once Bent Flashing	11.6	7	14
B	65mm X 80mm Internal 95° Once Bent Flashing	11.6	7	14
C1	80mm x 50mm x 15mm External Drip	11.6	7	14
C2	80mm x 75mm x 15mm External Drip	10.9	6	12
C3	80mm x 105mm x 15mm External Drip	11	5	10
CT	75mm x 25mm x 11mm Chase Trim (Only in Blue Grey)	11.6	9	18
D	160mm x 80mm x 10mm Upstand Flashing	10.6	4	8
E	80mm x 30mm x 75mm x 15mm External Drip with Water Check	11	5	10
F	80mm x 30mm x 125mm x 15mm External Drip with Water Check	10.6	4	8

# Technical data sheet

<b>Storage guidance</b>	The product should be stored dry, protected against weathering, and must not be exposed to temperatures exceeding 35°C. The products must not be exposed to a direct naked flame or other ignition sources, or to solvents or other chemicals. Ensure the product(s) are clear of buildings and any other storage areas. Where there are storage containers on site, these may be suitable for storing products.
<b>Packaging material</b>	The product will be delivered in polyethylene wrap (readily recyclable).
<b>Handling/PPE</b>	All persons using the product should be fully aware of the manual handling methods as roofing materials are heavy and can cause serious injury. When using the product, installers should be provided with, and wear, suitable personal protective equipment.
<b>Disposal guidance</b>	Disposing of any waste material must be carried out in accordance with national regulations. Recommended EWC waste codes: 17 09 04 mixed construction and demolition wastes other than those mentioned in 17 09 01, 17 09 02 and 17 09 03.
<b>Further information/ documents</b>	Current documents such as brochures, installation guides, etc. can be found by visiting <a href="http://www.bauder.co.uk">www.bauder.co.uk</a>
<b>International Standards Organisation (ISO)</b>	<b>ISO 9001:2015 Quality Management</b> Certificates EN1271 (UK) and 70499/03-15_e (Germany)  <b>ISO 14001:2015 Environmental Management Certificates</b> A10552 (UK) and 70499/03-15_d (Germany)

## Installation Guidance

Align and make parallel all pieces of pre-coated metal allowing for a 2-3mm expansion gap.  
Ensure fixings at the base of an upstand are made in the flat area, avoid fixings into the upstand. If unavoidable, contact Bauder for advice and support.  
Position fasteners to ensure they are at least 25mm from the edge of any piece of pre-coated metal.  
Weld a cover strap min 150mm wide to seal the joints.  
Leave a 40mm wide unwelded central gap of cover strip between metal sections to allow a sufficient area of membrane for expansion and contraction movement in the joint.

Fixing torque – all metal should be installed with a clutch mechanism screw-gun with torque settings to ensure fixings are at correct tension otherwise the metal will depress and need replacing.

Safety Data Sheets are designed to provide the necessary information to recipients of substances and mixtures in the EU & UK. This product is classed as an article; therefore, this product does not have a requirement for a Safety Data Sheet.

